

# FOR LEASE

**121<sup>st</sup> Ave. Business Park**  
**20,000 SF (Divisible to 10,000 SF)**

**12001 NE 60<sup>th</sup> Way**  
**Vancouver, WA**

## Suite A-1:

- 10,000 SF Shell
- 2,067 SF Showroom/Office
- 1 Grade & 1 Dock Door

## Suite A-4:

- 10,000 SF Shell
- 1,720 SF Office, Mezzanine
- 1 Grade & 1 Dock Door

20' Clear Height

480 Volt, 3 Phase Power

Communication: T1 Lines

## Combined Total (Suite A-1 & A-4):

- 20,000 SF with 3,787 SF Showroom, Office and Mezzanine areas
- 2 Grade Doors
- 2 Dock Doors

## Rates:

**\$.40 psf per month shell + NNN**

**\$.75 psf per month office surcharge**

For more information contact

**Dave Brown**

**(360) 735-8001**

[www.ColumbiaCommercial.com](http://www.ColumbiaCommercial.com)

**NOTE: Nearby paved & fenced lot  
FOR LEASE**

**at the Life Business Center,  
located at NE 121<sup>st</sup> Ave. and NE 56<sup>th</sup> St.**

9120 NE Vancouver Mall Loop, Suite 200  
Vancouver, WA 98662  
PO Box 820406, Vancouver, WA 98682  
PH: (360) 735-8001  
FX: (360) 735-8033



1672 Willamette Falls Dr., Suite E  
PO Box 46  
West Linn, Oregon 97068  
PH: (503) 650-5300  
FX: (503) 650-5343

**COLUMBIA COMMERCIAL PROPERTIES, LLC**

[www.ColumbiaCommercial.com](http://www.ColumbiaCommercial.com)

The information contained herein has been obtained from sources we deem reliable.  
We do not, however, guarantee its accuracy. All information should be verified prior to purchase or lease.

# Site and Floor Plans

12001 NE 60<sup>th</sup> Way  
Vancouver, WA 98682

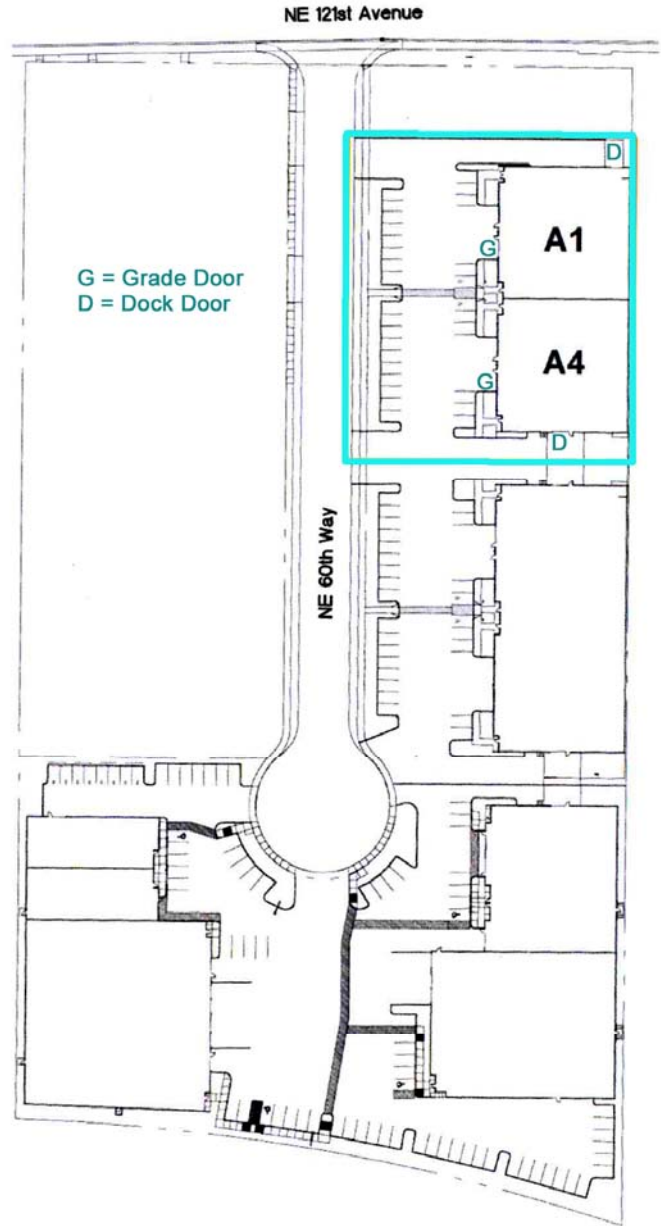
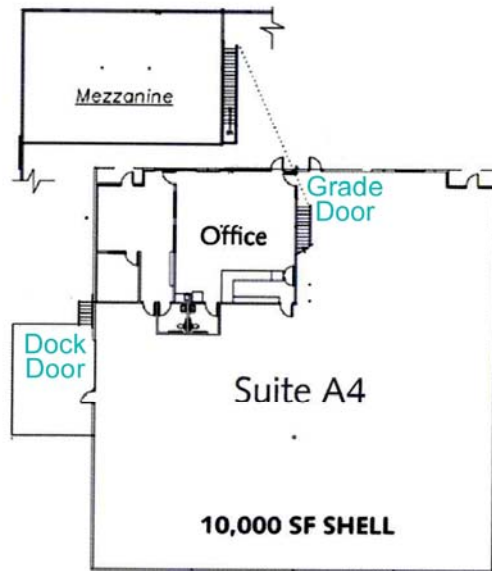
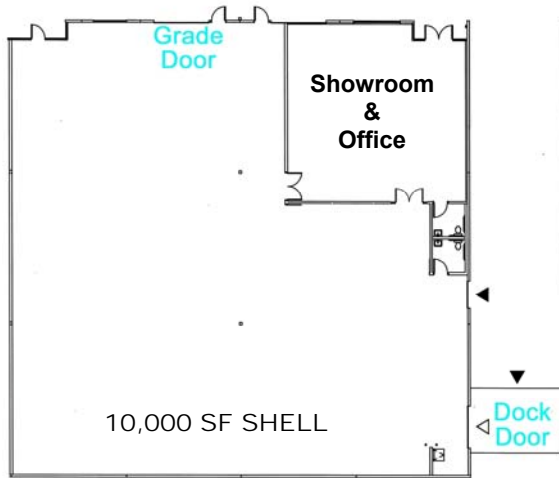

**10,000 – 20,000 SF  
Warehouse**

**NOTE:  
33,541 SF paved & fenced lot  
FOR LEASE at the  
Life Business Center  
(South on NE 121<sup>st</sup> Ave. & NE 56<sup>th</sup> St.)**